

6-8FT TABLETOP WAVE SERIES To Install

Frame Installation

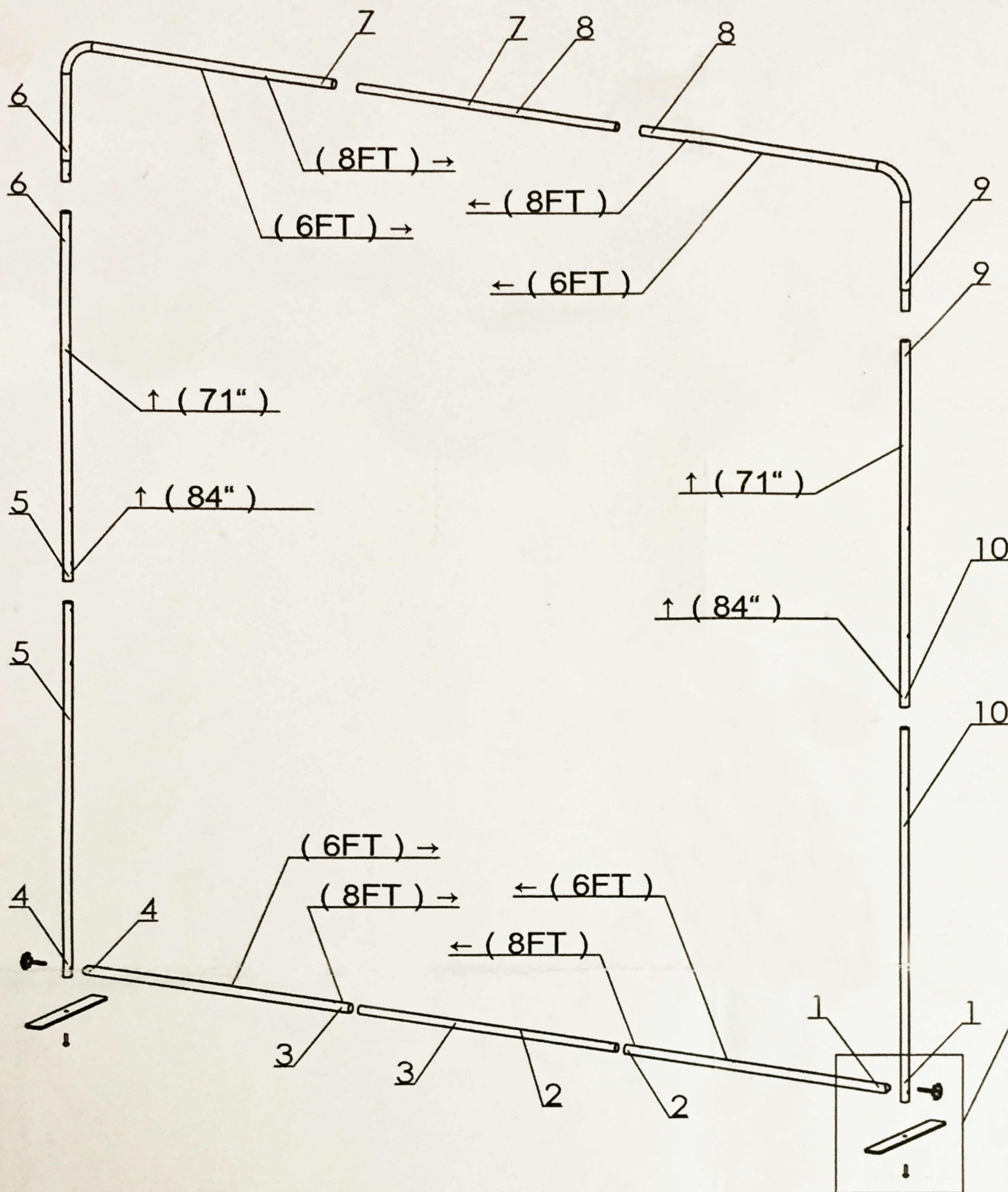

1. The horizontal pipes could be adjust to 6ft or 8ft
2. The vertical pipes could be adjust to 71" or 84"

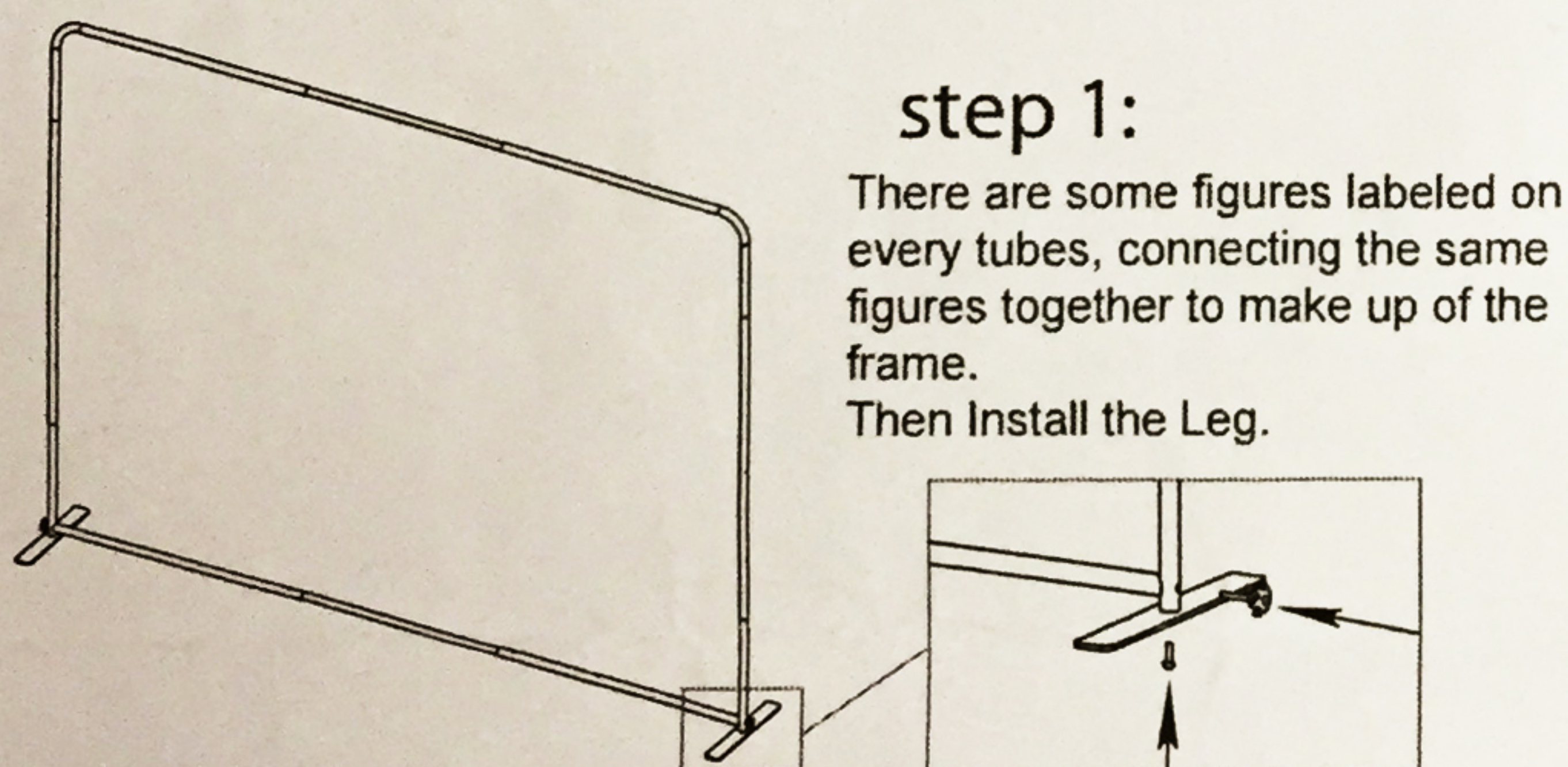
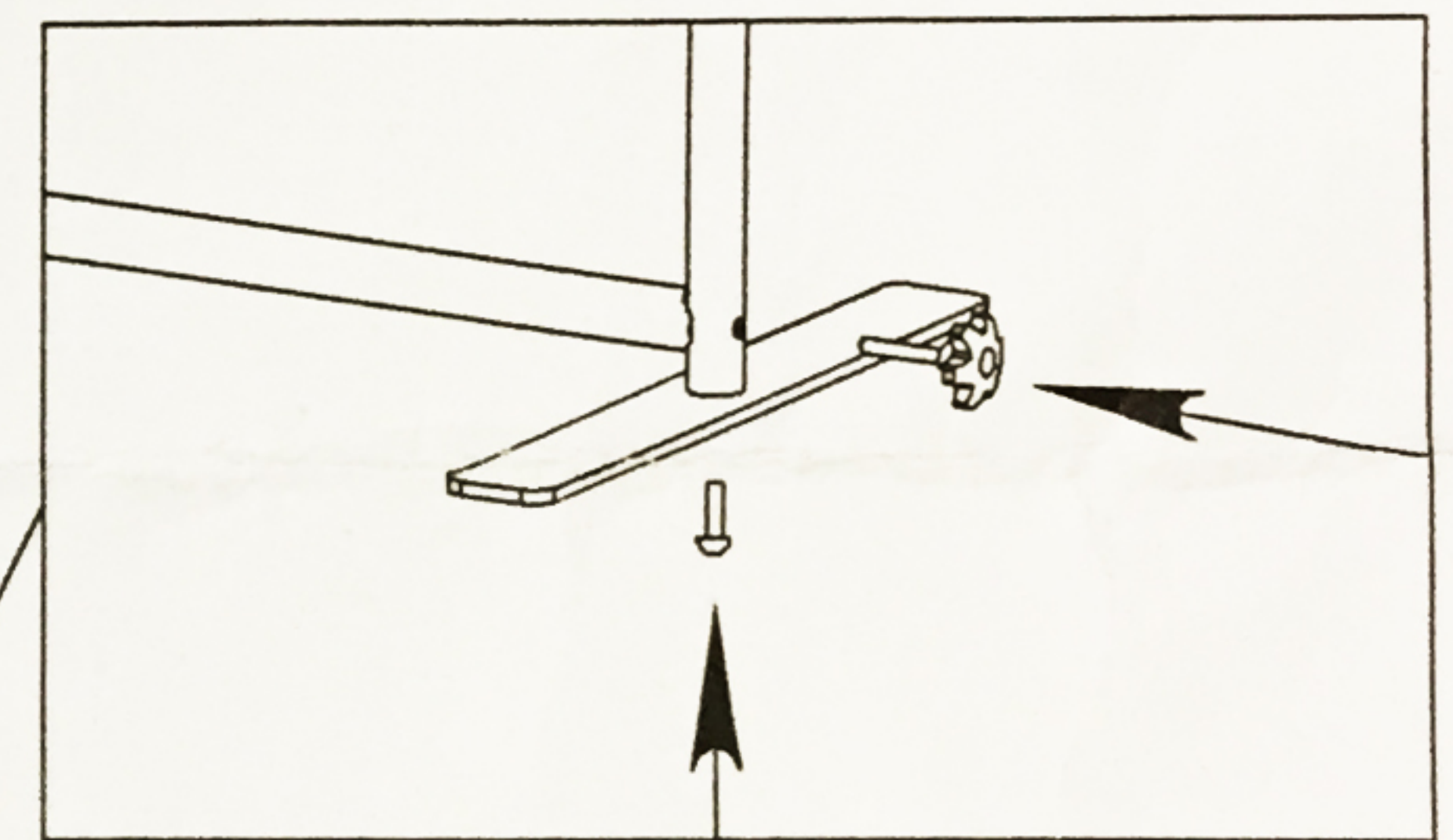

step 1:

There are some figures labeled on every tubes, connecting the same figures together to make up of the frame.
Then Install the Leg.

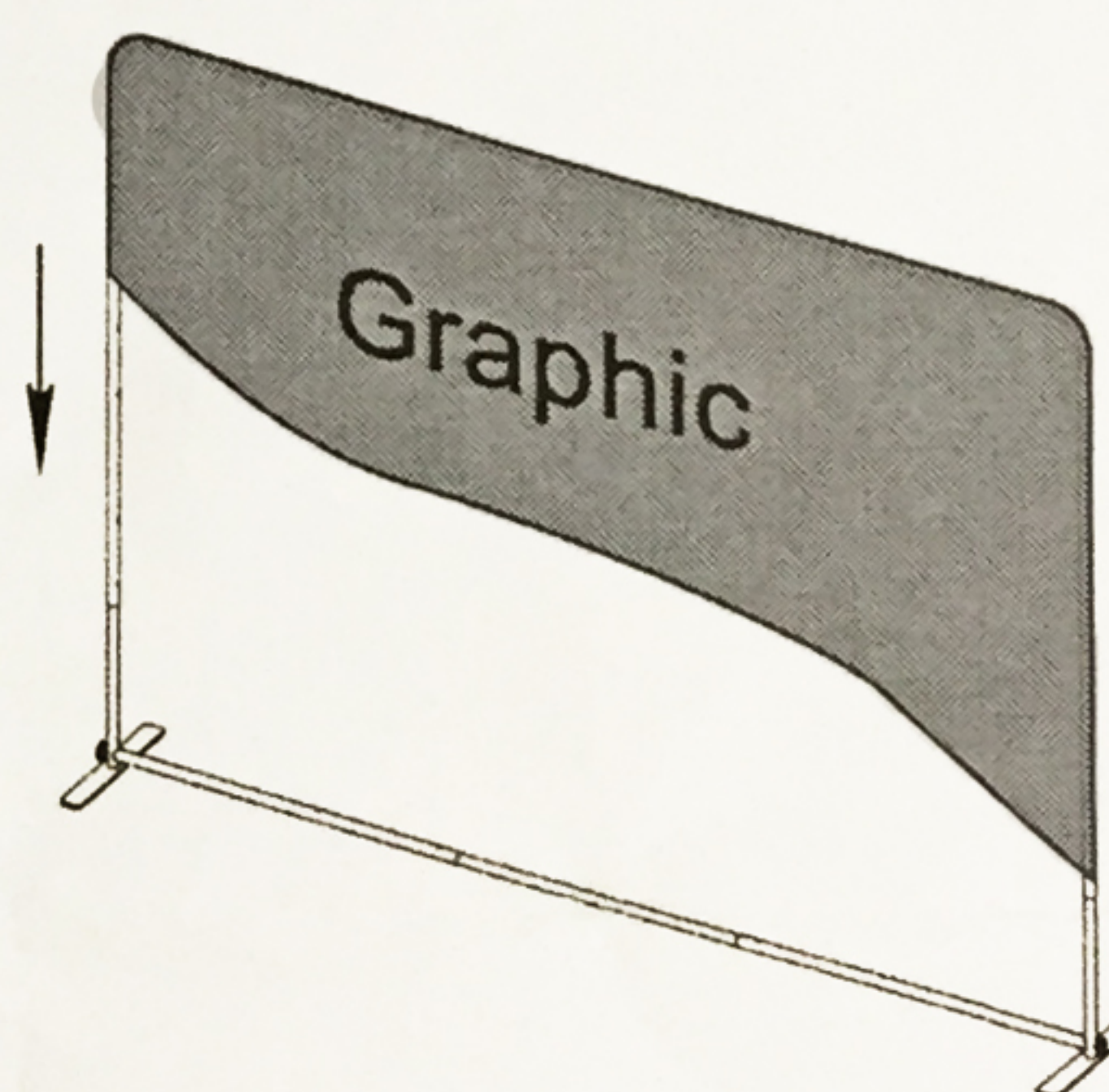
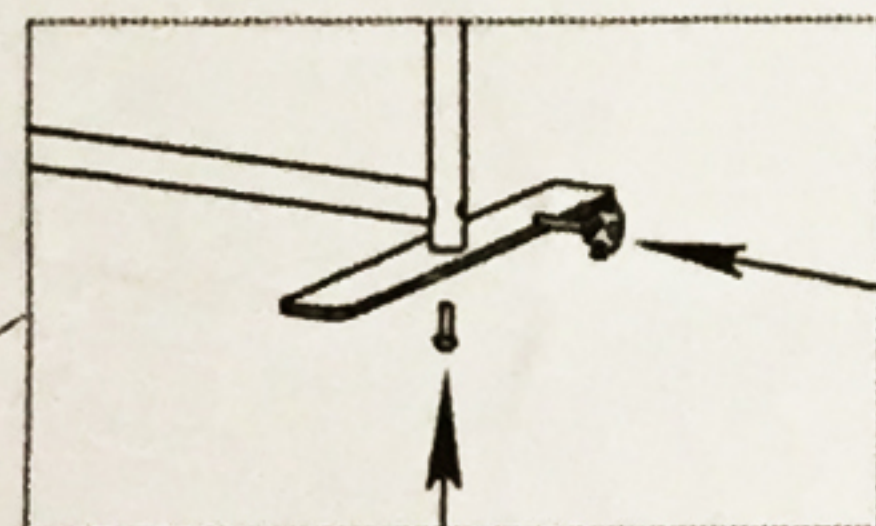

step 2:

Put the graphic on the ready frame.

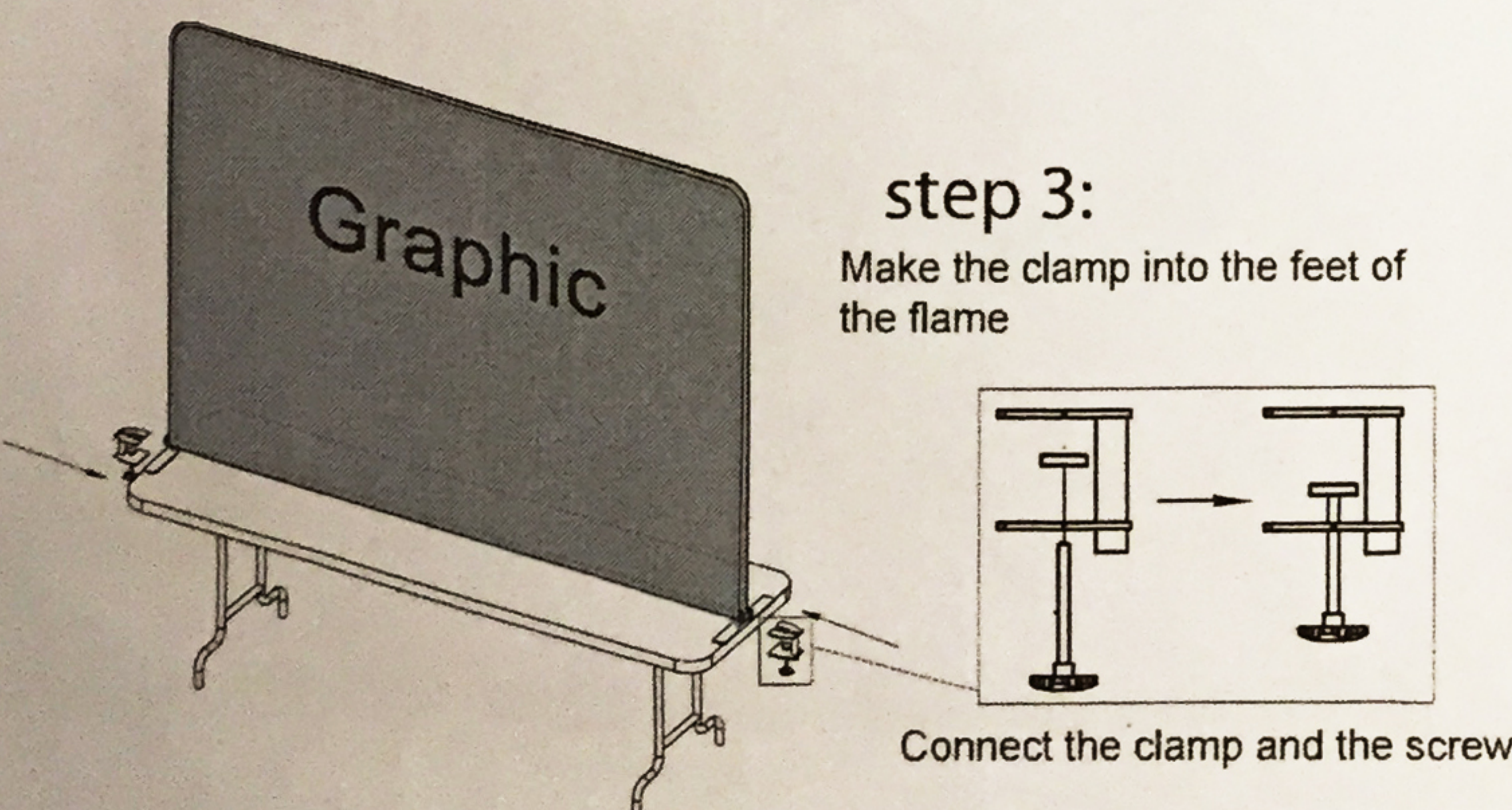

step 3:

Make the clamp into the feet of the frame

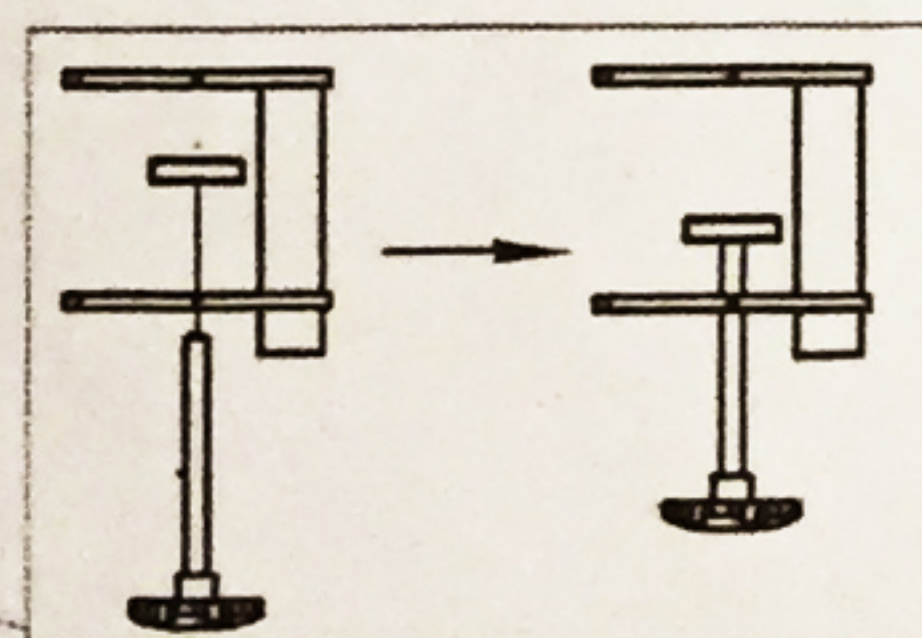

Connect the clamp and the screw

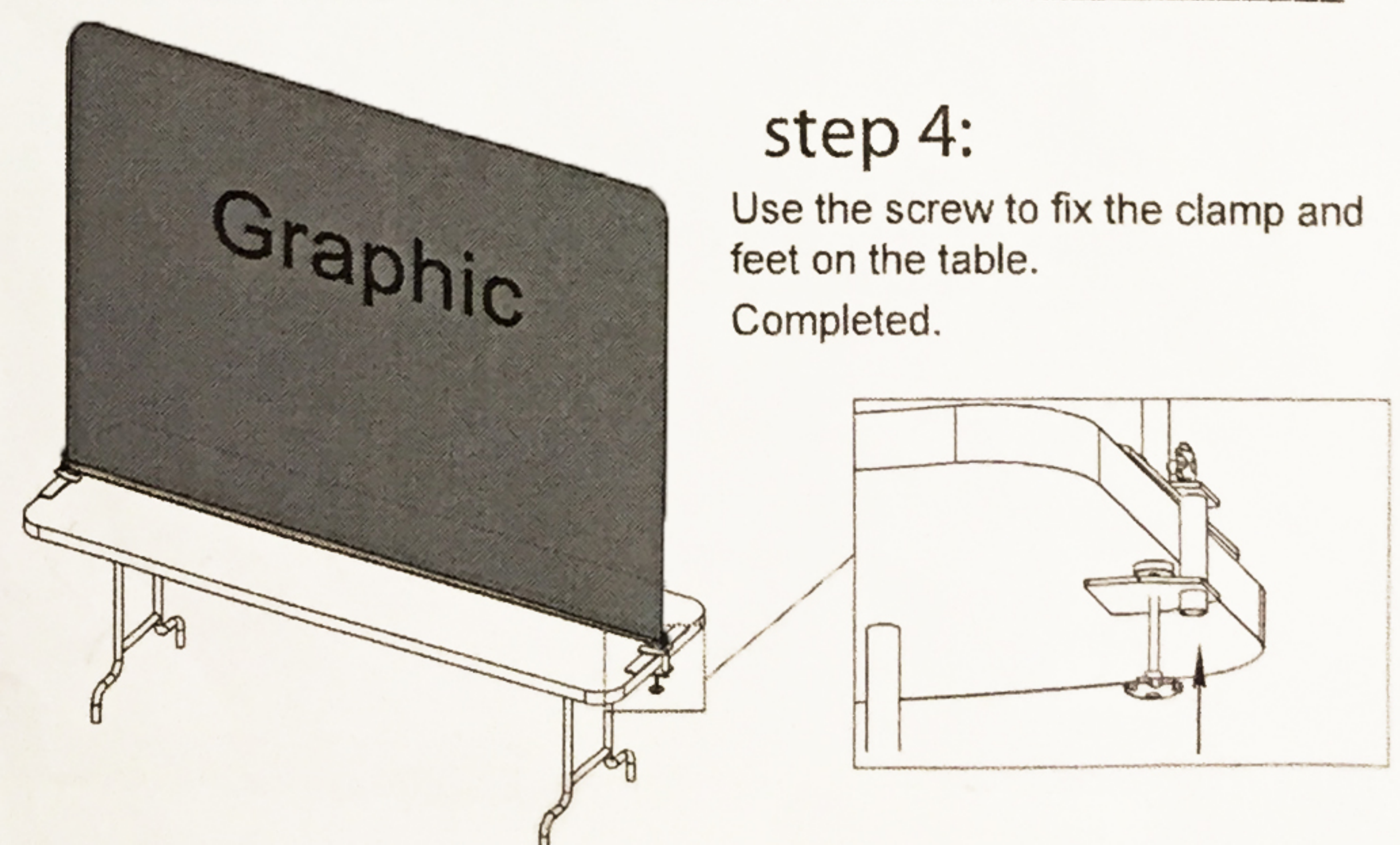

step 4:

Use the screw to fix the clamp and feet on the table.
Completed.

